

Model 6 parts layout

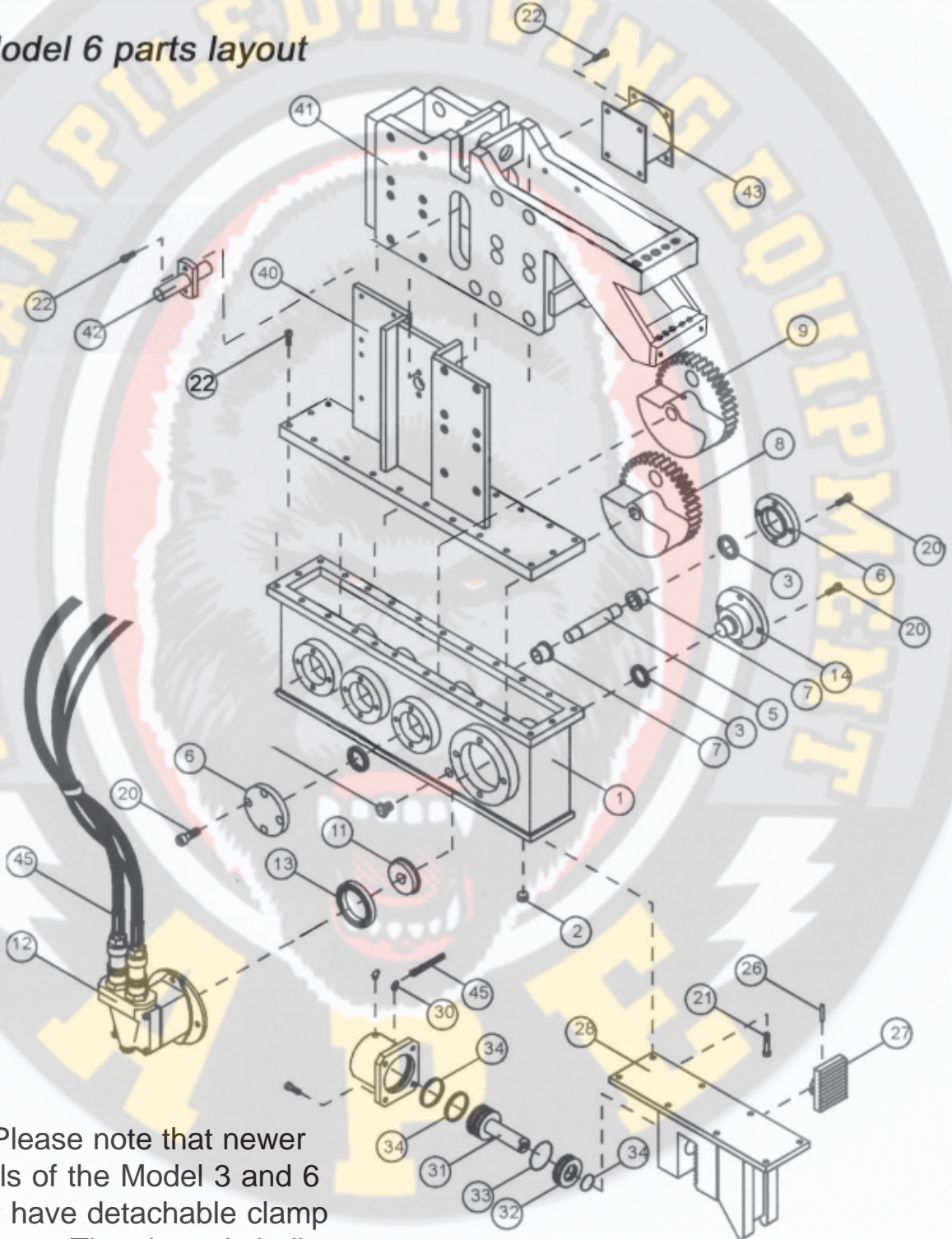

Please note that newer models of the Model 3 and 6 do not have detachable clamp systems. The clamp is built into the gearbox as shown on the front cover.



OPERATION / MAINTENANCE MANUAL

MODEL 3 & 6 VIBRATORY HAMMER WITH MODEL 14 POWER UNIT

7032 SOUTH 196th - KENT, WA. 98032 - (206) 872-0141 / FAX (206) 872-8710

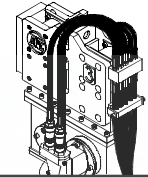

II. MAJOR COMPONENT DEFINITION - Model 6

II-1a. Component Identification

The following is a general listing of the APE 6 Major components and part numbers. (Please see Figure 2-A. for component location).

Table 2-A. Component Identification.

| Item | Qty | Description | Part # |
|------|-----|---------------------------------|---------|
| 1 | 1 | Vibratory Gearbox | #107001 |
| 2 | 1 | Magnetic Drain Plug | #105004 |
| 3 | 7 | Eccentric Bearing | #105101 |
| 4 | | | |
| 5 | 3 | Eccentric Shaft | #105103 |
| 6 | 6 | Eccentric Bearing Cover | #105104 |
| 7 | 6 | Bearing Sleeve | #105105 |
| 8 | 1 | Eccentric Weight - Driver | #105106 |
| 9 | 3 | Eccentric Weight - Driven | #105107 |
| 10 | | | |
| 11 | 1 | Motor Bearing Carrier | #105110 |
| 12 | 1 | Motor - Volvo #F11-10-HU-CH-K | #105201 |
| 13 | 1 | Motor - Bearing | #105202 |
| 14 | 1 | Motor Bearing Cover | #105205 |
| 15 | 1 | Sight Glass #LSP151-05 3/4"NPT | #105305 |
| 16 | --- | ----- | ----- |
| 17 | --- | ----- | ----- |
| 18 | --- | ----- | ----- |
| 19 | --- | ----- | ----- |
| 20 | 1 | Model 3/6 Bolt Kit - Gearbox | #105410 |
| 21 | 1 | Model 3/6 Bolt Kit - Clamp | #105420 |
| 22 | 1 | Model 3/6 Bolt Kit - Suppressor | #105430 |
| 23 | --- | ----- | ----- |
| 24 | --- | ----- | ----- |
| 25 | 1 | 1/8" Grease Zert | #205101 |
| 26 | 1 | Jaw Pin | #205102 |
| 27 | 1 | Moveable Jaw | #205104 |
| 28 | 1 | Model 3 Clamp Body | #205119 |
| 29 | 1 | Clamp Cylinder | #205501 |
| 30 | 2 | #6SAE/#6JIC 45 deg. Fitting | #205502 |
| 31 | 1 | Plunger Shaft | #205503 |
| 32 | 1 | Cylinder End Cap | #205504 |
| 33 | 1 | Model 3/6 Clamp O-Ring Kit | #205509 |
| 34 | 1 | Model 3/6 Clamp Seal Kit | #205510 |
| 35 | --- | ----- | ----- |
| 36 | --- | ----- | ----- |
| 37 | --- | ----- | ----- |
| 38 | --- | ----- | ----- |
| 39 | --- | ----- | ----- |
| 40 | 1 | Model 6 Inner Suppressor | #307103 |
| 41 | 1 | Model 6 Outer Suppressor | #307102 |
| 42 | 1 | Model 3/6 Suppressor Safety Pin | #305016 |
| 43 | 4 | Model 3/6 Elastomers | #305104 |
| 44 | --- | ----- | ----- |
| 45 | 1 | Model 3/6 Hose Kit | #405100 |

2 left and 2 right gear cut

It is necessary to replace all eccentrics when rebuilding a Model 3 or 6 gearbox to insure gear cut alignment.